

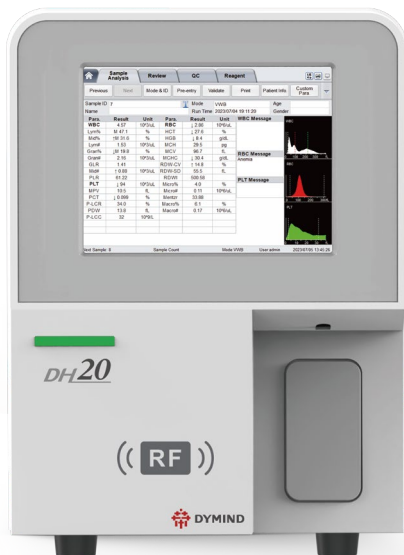

DYMIND

**COMPACT YET
POWERFUL**



- Compact and user-friendly
- More clinical parameters
- Only 9ul sample volume
- Optional RF card and barcode function

DH20

Auto Hematology Analyzer

Principle Impedance method for WBC, RBC and PLT test Cyanide free colorimetry for HGB test	Parameter 21 Reportable parameters <ul style="list-style-type: none"> •WBC •MCH •MPV •Lym# •Mid% •RBC •MCHC •PDW •Lym% •HGB •RDW-CV •P-LCR •Gran# •HCT •RDW-SD •P-LCC •Gran% •MCV •PLT •PCT •Mid# 8 Researchable parameters <ul style="list-style-type: none"> • PLR • Macro% • GLR • Macro# • RDWI • Mentzr • Micro% • Micro# 																			
Throughput 30T/H	Sample Mode Whole blood, capillary blood, pre-diluted blood	Sample Volume ≤9uL (whole blood)																		
Dimension ≤ 270 mm(W), ≤ 375mm(H), ≤ 350 mm(D)	Display 8 inches color touchscreen	Data Storage 200,000																		
Graph 3 histograms	Performance <table border="1"> <thead> <tr> <th>Parameter</th> <th>Linearity Range</th> <th>Precision (CV %)</th> </tr> </thead> <tbody> <tr> <td>WBC (10⁹/L)</td> <td>0-100</td> <td>≤3.5% (3.50-7.00) ≤2.5% (7.01-15.00)</td> </tr> <tr> <td>RBC (10¹²/L)</td> <td>0-8.50</td> <td>≤2.0% (3.50-6.50)</td> </tr> <tr> <td>HGB (g/L)</td> <td>0-250</td> <td>≤1.5% (100-180)</td> </tr> <tr> <td>MCV (fL)</td> <td>/</td> <td>≤1.0% (70.0-110.0)</td> </tr> <tr> <td>PLT (10⁹/L)</td> <td>0-1000</td> <td>≤4.0% (150-500)</td> </tr> </tbody> </table>		Parameter	Linearity Range	Precision (CV %)	WBC (10 ⁹ /L)	0-100	≤3.5% (3.50-7.00) ≤2.5% (7.01-15.00)	RBC (10 ¹² /L)	0-8.50	≤2.0% (3.50-6.50)	HGB (g/L)	0-250	≤1.5% (100-180)	MCV (fL)	/	≤1.0% (70.0-110.0)	PLT (10 ⁹ /L)	0-1000	≤4.0% (150-500)
Parameter	Linearity Range	Precision (CV %)																		
WBC (10 ⁹ /L)	0-100	≤3.5% (3.50-7.00) ≤2.5% (7.01-15.00)																		
RBC (10 ¹² /L)	0-8.50	≤2.0% (3.50-6.50)																		
HGB (g/L)	0-250	≤1.5% (100-180)																		
MCV (fL)	/	≤1.0% (70.0-110.0)																		
PLT (10 ⁹ /L)	0-1000	≤4.0% (150-500)																		
Data Transmission Bi-directional LIS	Power Environment 100V ~ 240V, 50/60Hz																			
Operating Environment <ul style="list-style-type: none"> • Working environment: 15°C ~ 32°C • Relative humidity: 30% ~ 85% • Atmospheric pressure: 70kPa ~ 106kPa 	Printout <ul style="list-style-type: none"> • Internal printer: internal thermal printer with various formats • External printer: compatible with multiply laser / inkjet printers 																			

More clinical parameters

Now, more researchable parameters such as PLR, GLR, RDWI, Micro%, Micro#, Macro%, Macro#, Mentzr are available with higher clinical meaning of anemia, infection, etc



More thoughtful functions

We provide a thoughtful reagent solution of closed system with optional **RF card** or **barcode** according to your requirements



Less reagent consumption

We decrease the unnecessary reagent waste and maintenance, which reduces the maintenance reagent consumption by 20%

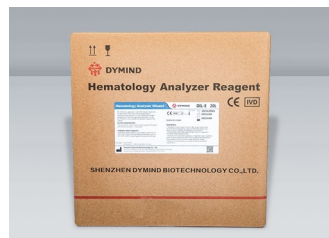

Less operation time

The common shut-down time has been reduced to 5 minutes and maintenance time, such as exiting hibernation, has been reduced by 25%, because the fluid circuit and software have been optimized

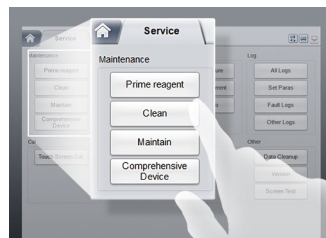

10th Floor, Building B, High-tech Park, Guangqiao Road, Tianliao Community, Yutang Street, Guangming District, Shenzhen 518107, P. R. China

+86-755-26008015-8123

Intl@dymind.com

www.dymind.com

Declaration:

1. Shenzhen Dymind Biotechnology Co., Ltd. reserves the right to change or modify any of the product description and specifications
 2. Shenzhen Dymind Biotechnology Co., Ltd. reserves the right of final decision and interpretation in case of any dispute.

P/N: DH20 [1.0]

